

ERMA EM1

Selbstlader

cal. 22 L.R.

War II. More than 7.000.000 pieces have been produced. ERMA presents a similar type



ERMA EM1 Semi-automatic Carbine cal. 22 L. R.

● light ● very handy ● excellent appearance ●

Specifications

Mechanism type: semi-automatic, blowback
Barrel length: 450 mm (18")
Sights: aperture rear adjustable for windage and elevation (25/50/75/100 m), blade front with strong sight protector
Distance between sights: 530 mm (20.9")
Stock: polished beech wood with handguard or oiled walnut, sling swivel
Magazine: for 10 rounds cal. 22 L. R.; also available 15 rounds magazine
Safety: safety lever on the right side of the trigger guard
Over-all length: 900 mm (35.4")
Weight: 2.55 kos. (5.6 lbs.)

Instruction of use:

Safety on the right side of the trigger guard is engaged when safety lever points down (white point). To disengage rotate safety lever forward (red point).

To load, engage safety, and insert the filled magazine into magazine opening, making sure magazine snaps into place. Hook over operating slide handle, pull operating slide to the rear and release it (the closing of the bolt must be done by spring pressure). Disengage safety and pull the trigger.

Bolt remains open when magazine is empty. Push magazine catch to the left and withdraw magazine. Now bolt closes.

Disassembly Procedure:

Loosen front band screw (55), remove rear guard screw (63), slip front band (54) forward on barrel, and lift wooden handguard (61) free.

Separate barrel and receiver assembly from stock.

Push both trigger housing retaining pins (37) out of receiver and remove receiver screw (38).

Lift receiver (36) free (push downwards with finger tip the bolt).

Pull operating slide (41), operating slide spring (40), and operating slide spring guide (4) forward.

Raise recoil plate (35) and remove to rear firing pin spring (33), firing pin piece (32) together with bolt.

From the same manufacturer: ERMA-Luger 22 Pistol

The U. S. M 1 Carbine cal. 30 was the most popular military rifle of World

in modern pattern as a Sporting and Target Gun in cal. 22 L. R.

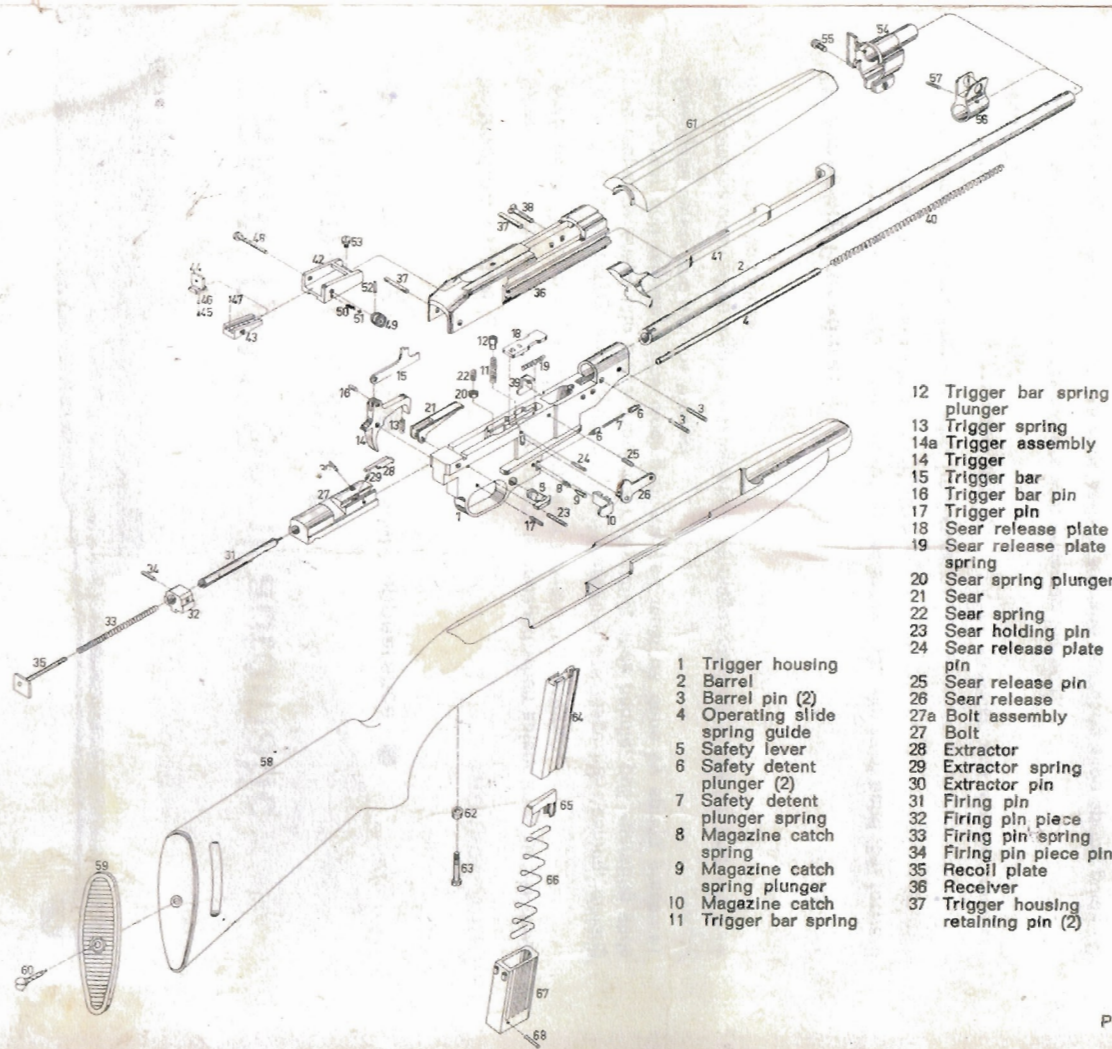

- 1 Trigger housing
- 2 Barrel
- 3 Barrel pin (2)
- 4 Operating slide spring guide
- 5 Safety lever
- 6 Safety detent plunger (2)
- 7 Safety detent plunger spring
- 8 Magazine catch spring
- 9 Magazine catch spring plunger
- 10 Magazine catch
- 11 Trigger bar spring

- 12 Trigger bar spring plunger
- 13 Trigger spring
- 14a Trigger assembly
- 14 Trigger
- 15 Trigger bar
- 16 Trigger bar pin
- 17 Trigger pin
- 18 Sear release plate
- 19 Sear release plate spring
- 20 Sear spring plunger
- 21 Sear
- 22 Sear spring
- 23 Sear holding pin
- 24 Sear release plate pin
- 25 Sear release pin
- 26 Sear release
- 27a Bolt assembly
- 27 Bolt
- 28 Extractor
- 29 Extractor spring
- 30 Extractor pin
- 31 Firing pin
- 32 Firing pin piece
- 33 Firing pin spring
- 34 Firing pin piece pin
- 35 Recoil plate
- 36 Receiver
- 37 Trigger housing retaining pin (2)

- 38 Receiver screw
- 39 Ejector
- 40 Operating slide spring
- 41 Operating slide
- 42a Rear sight assembly
- 42 Rear sight base
- 43 Rear sight ramp
- 44 Rear sight sliding aperture
- 45 Rear sight sliding spring
- 46 Rear sight sliding ball
- 47 Rear sight ramp pin
- 48 Rear sight windage screw
- 49 Rear sight windage knob
- 50 Windage stop spring
- 51 Windage stop ball
- 52 Windage stop pin
- 53 Rear sight base screw
- 54 Front band assembly
- 55 Front band screw
- 56 Front sight assembly
- 57 Front sight pin
- 58a Stock assembly
- 58 Stock (polished beech or oiled walnut)
- 59 Butt plate
- 60 Butt plate screw
- 61 Handguard assembly
- 62 Rear guard screw plunger
- 63 Rear guard screw
- 64a Magazine assembly
- 64 Magazine tube
- 65 Magazine follower
- 66 Magazine spring
- 67 Magazine tube holder
- 68 Magazine tube holder pin